

B65 GLEISDORFER STRASSE

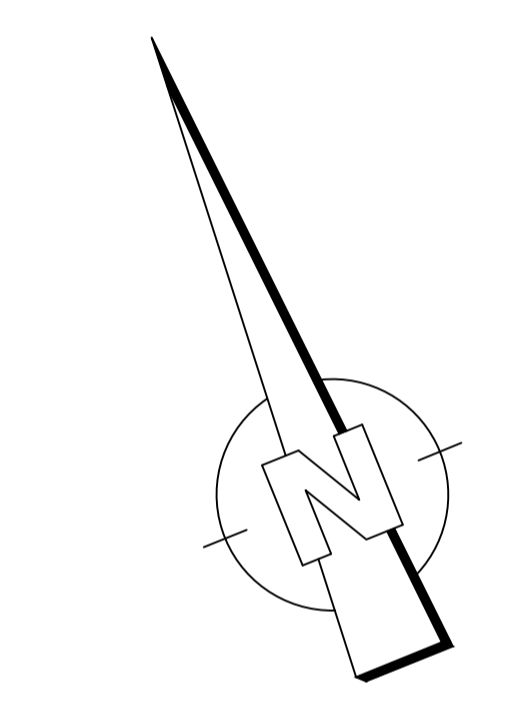
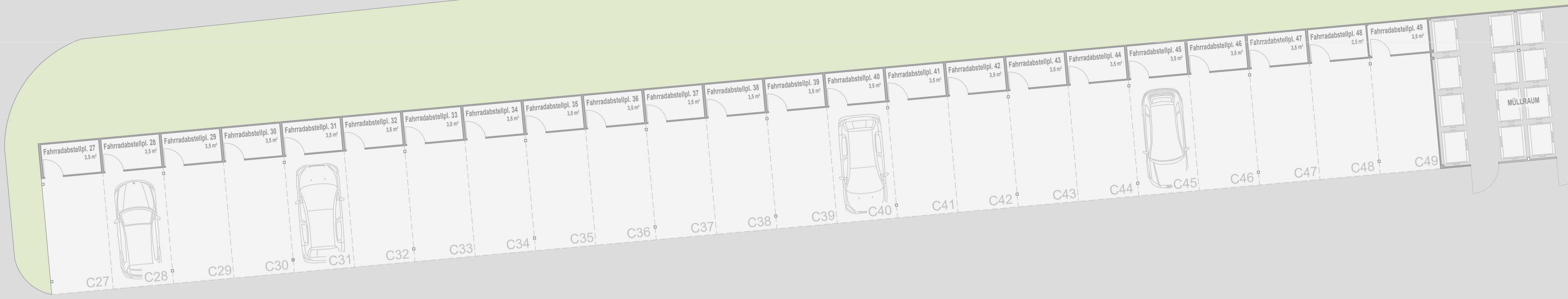

Haus 185

TOP 05 Obergeschoss

Wohnfläche	67,70 m ²
Abstellraum	2,12 m ²
Wohnnutzfläche	69,82 m²
Balkon	15,50 m ²
Gesamt Nutzfläche	85,32 m²

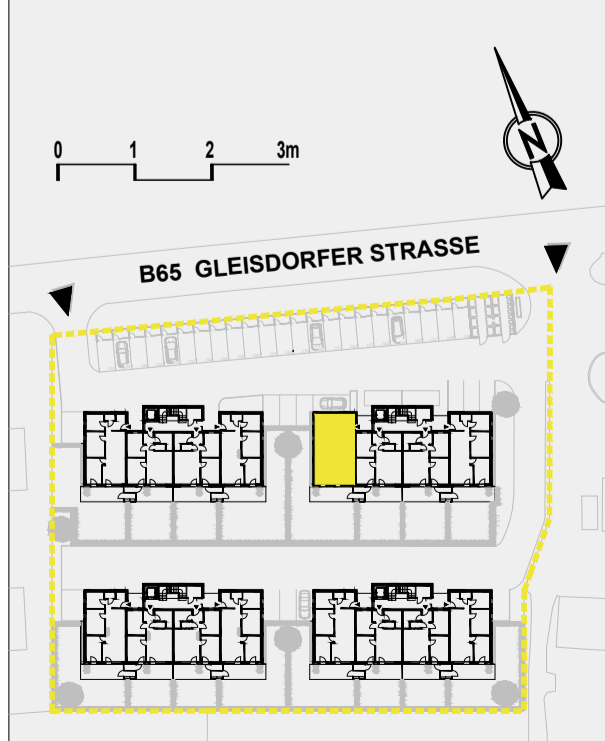

OBERGESCHOSS