

B65 GLEISDORFER STRASSE

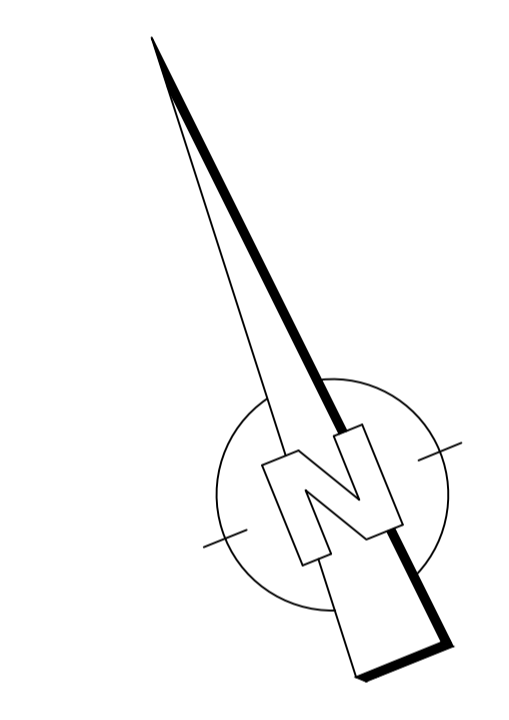
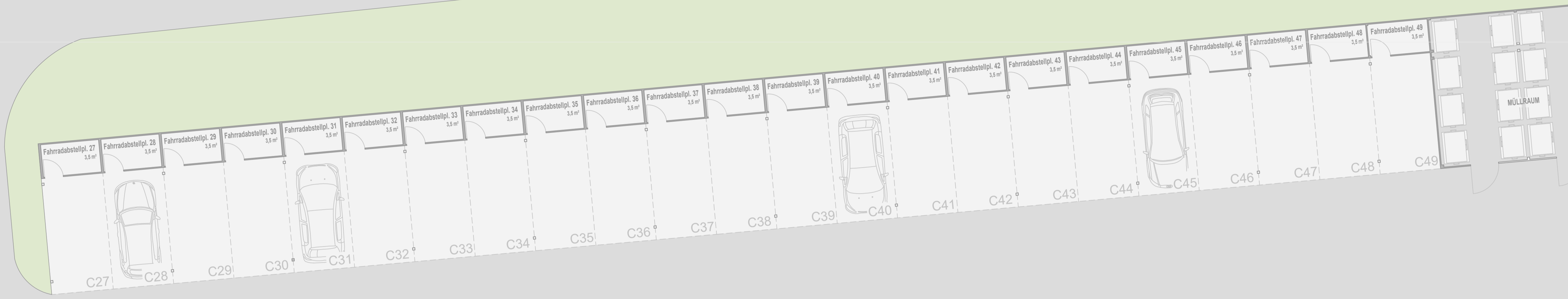

Haus 185

TOP 06 Obergeschoss

Wohnfläche	57,68 m ²
Abstellraum	2,12 m ²
Wohnnutzfläche	59,80 m²
Loggia	14,59 m ²
Gesamt Nutzfläche	74,39 m²

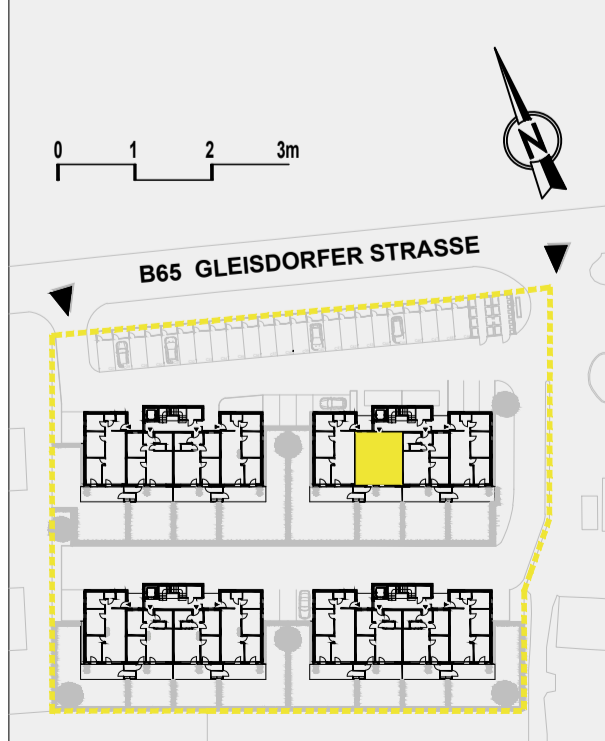

OBERGESCHOSS